

如何在 Android 平台下載及使用手機程式 “Moodle Mobile” How to install and use “Moodle Mobile” App in Android

您可能無法使用 Android 內置的網頁瀏覽器或者其他品牌的網頁瀏覽器如 “Google Chrome” 去閱讀本學院的 “Moodle” 學習系統內的電子書 pdf。以下的步驟包含如何安裝一個名為 “Moodle Classic” 的手機應用程式及如何使用該程式以閱讀電子書 pdf 的方法。

You may not be able to read pdf file if you use the default web browser or other browsers to access the College’s Moodle System (<https://moodle.ny.edu.hk>) in Android. Below are the steps to install an application called “Moodle Classic” which is fine for users to read pdf under our Moodle System.

- ➔ 首先，開啟 Play Store。
- ➔ First, open the Play Store.
- ➔ 在搜尋位置，輸入 “moodle classic”。
- ➔ In the search category, type in “moodle classic”.
- ➔ 安裝 “Moodle Classic” 手機程式。
- ➔ Install “Moodle Classic” App.

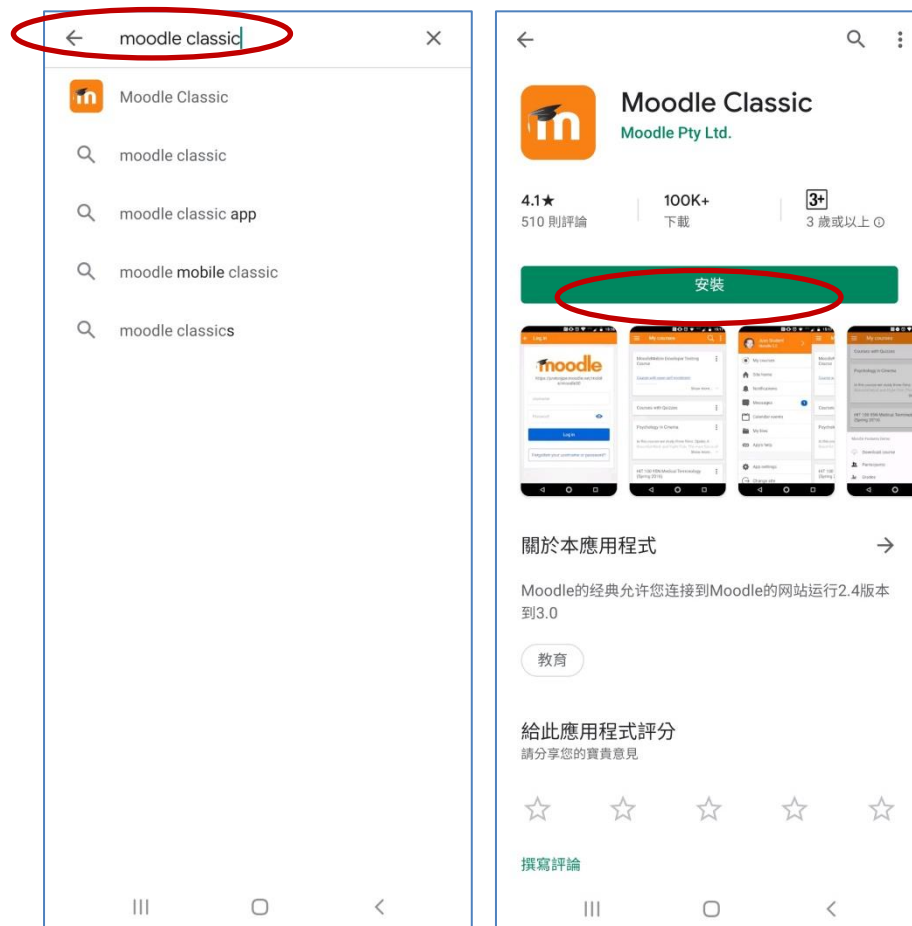

- 開啟 "Moodle Classic" 。
- Open the "Moodle Classic" App.

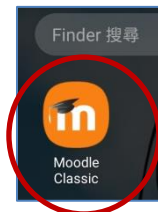

在網址欄，輸入 moodle.ny.edu.hk

- Type in Site URL, that is, moodle.ny.edu.hk
- 接著，按下「連接」按鈕。
- Press the "Connect" button
- 使用者名稱：(與學校網頁的學生編號一樣)，例如：20181234
- Username: (same as school website) e.g. 20181234
- 密碼與學校 Moodle 系統的密碼相同。
- Password: **Your Current Moodle Password.**
- 接著，按下「Log in」按鈕。
- Press the "Log in" button

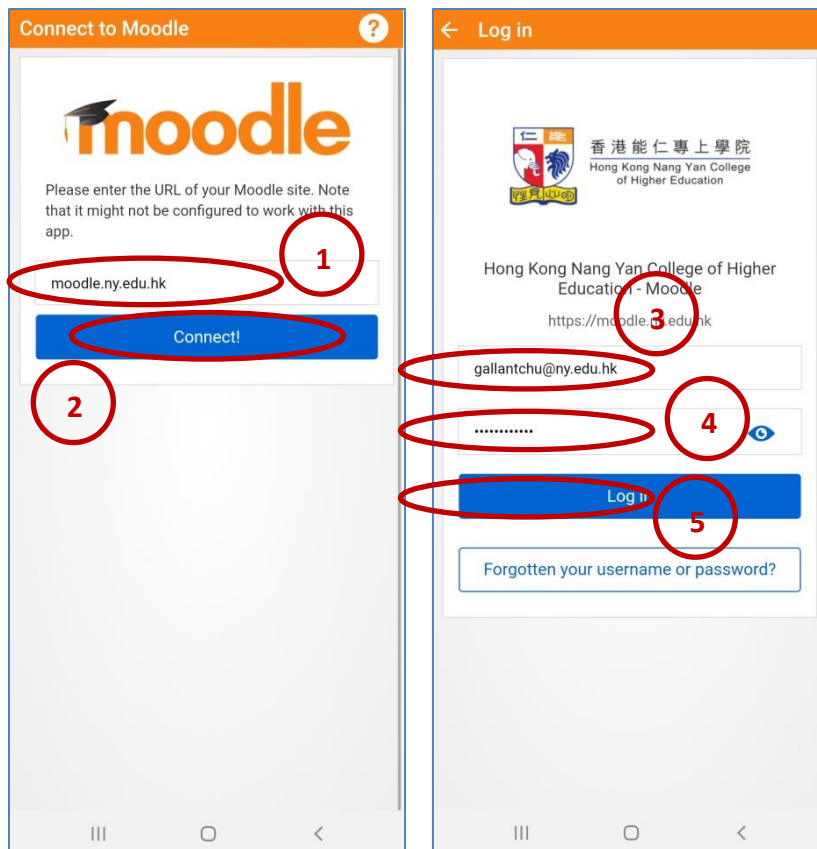

- 接著會出現帳戶驗正畫面，須時約數十秒。
- Time about 30 seconds is needed for login to be approved.
- 在“我的課程”裡面，會顯示您所選讀的所有課程。
- Inside “My Courses”, it will show all the courses you are enrolled.
- 按下「課程名稱」按鈕。
- Click the “Course Name” button.

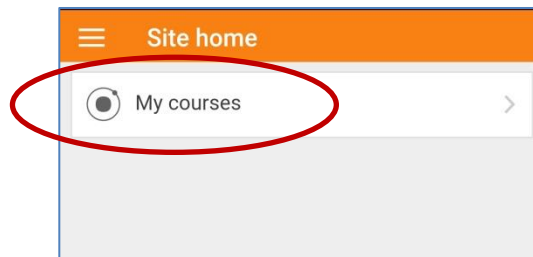

- 按下「教學周」以選擇不同的教學周筆記。
- Press the academic week button to view the notes of the week.
- 選擇課程筆記以閱讀該筆記。
- Then click the course materials to view the notes directly.

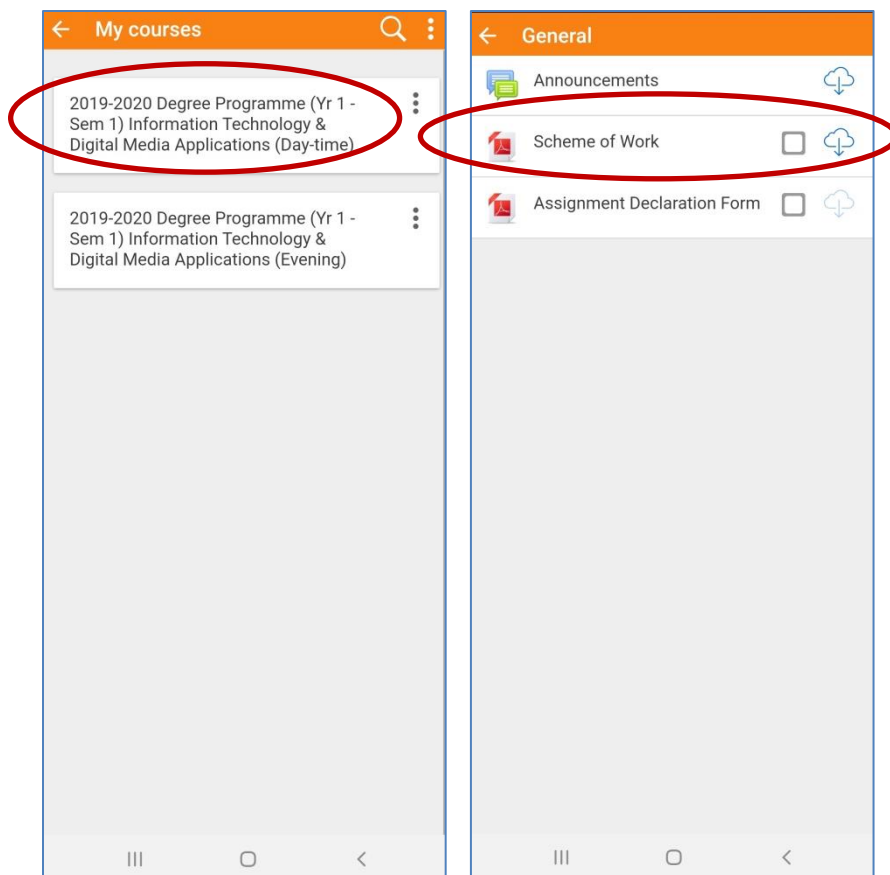

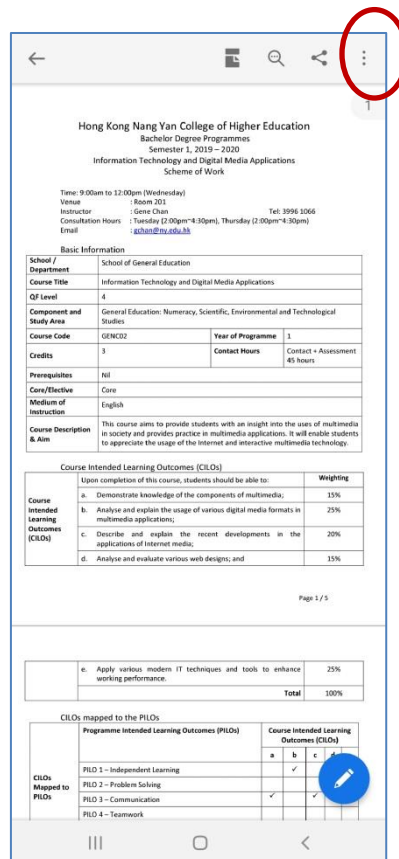
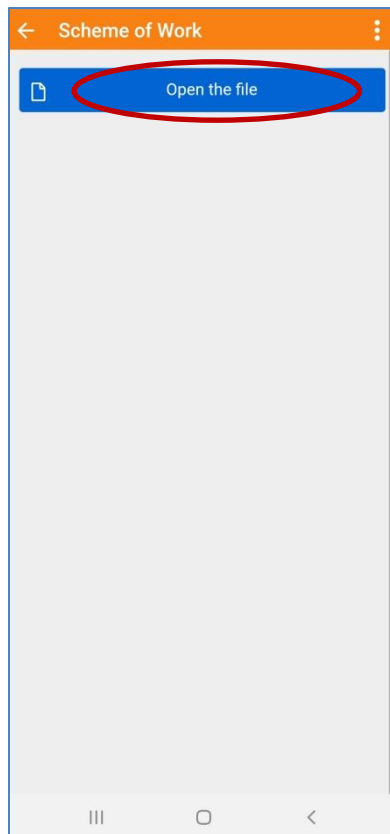

- 閱讀筆記內容前，按下“開啟文件”。
- Before viewing the pdf document, click the “Open the file”.
- 以下為查看筆記的畫面。
- Below is the screen showing the pdf file.
- 按下紅圈內的圖示以顯示其他選項。
- Press the button inside the red circle to have more options.

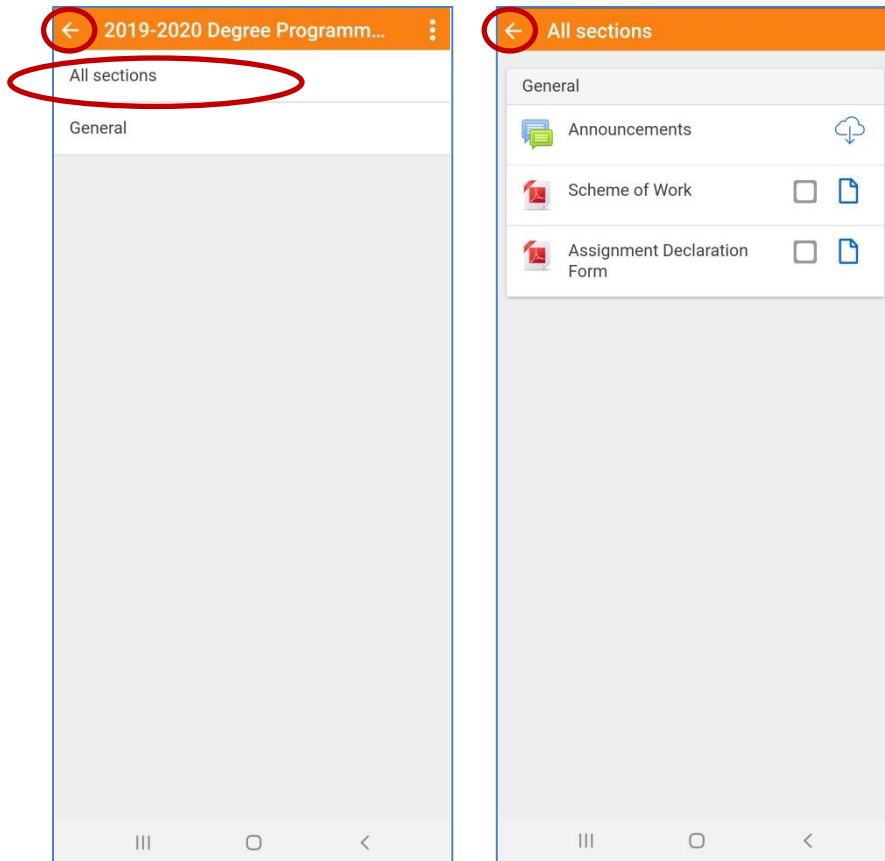

- 按下「全部顯示」，以選擇該課程所有筆記。
- Click “All sections” to view all the contents provided by the course.
- 按下「箭頭」以返回主目錄。
- Click “Arrow” to go back to the main page.



→ 在“我的課程”即主目錄，按下  以顯示其他選項。

→ In fact, inside the main menu, it shows “My courses”, then press the  button to access the other buttons.

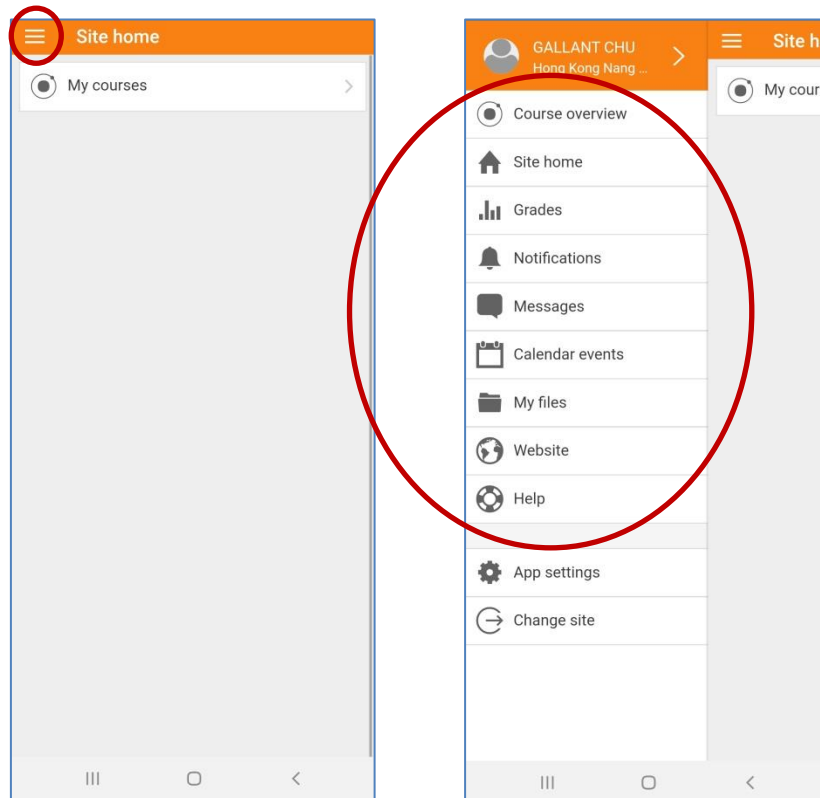

香港能仁專上學院 (Moodle) 版本為 3.4

Hong Kong Nang Yan College of Higher Education (Moodle) Ver. 3.4

本筆記的截圖為 Google Android 的 Moodle Classic 1.0.1 最新版本

The screen captures of the handout provided are from the latest version of Moodle Classic and that is the version of 1.0.1 in Google Android

Moodle 3.4 支援 Windows, Mac, Android 及 iOS 系統主流瀏覽器，如

Internet Explorer 11, Mozilla Firefox and Google Chrome

Moodle 3.4 is platform independent

一般行政、資訊科技及校園管理處

General Administration, IT Services and Campus Management Office

Email / 電郵: atmo@ny.edu.hk Hotline / 服務熱線: 3996 1052
